

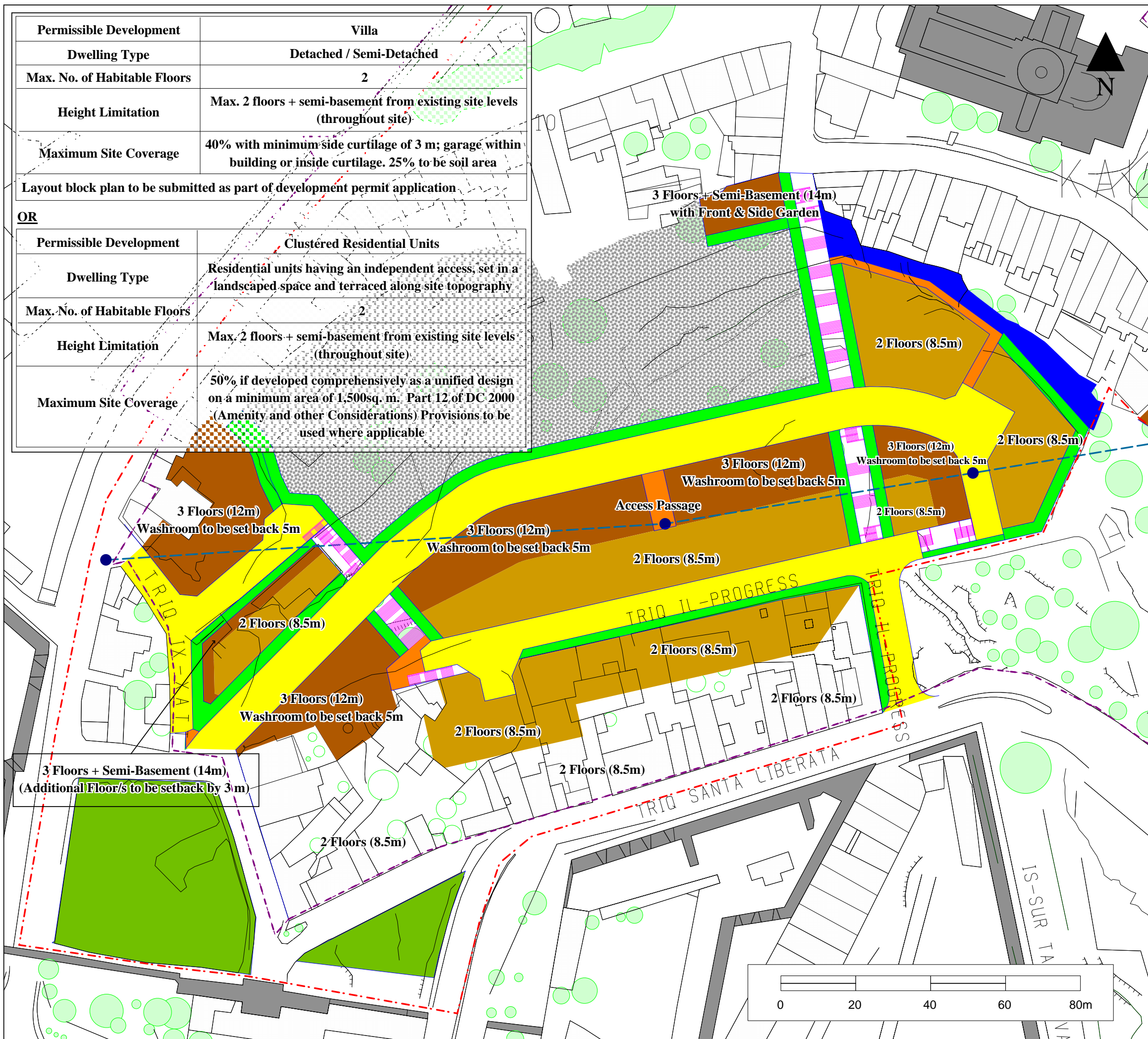

Permissible Development	Villa
Dwelling Type	Detached / Semi-Detached
Max. No. of Habitable Floors	2
Height Limitation	Max. 2 floors + semi-basement from existing site levels (throughout site)
Maximum Site Coverage	40% with minimum side curtilage of 3 m; garage within building or inside curtilage. 25% to be soil area
Layout block plan to be submitted as part of development permit application	

OR

Permissible Development	Clustered Residential Units
Dwelling Type	Residential units having an independent access, set in a landscaped space and terraced along site topography
Max. No. of Habitable Floors	2
Height Limitation	Max. 2 floors + semi-basement from existing site levels (throughout site)
Maximum Site Coverage	50% if developed comprehensively as a unified design on a minimum area of 1,500sq. m. Part 12 of DC 2000 (Amenity and other Considerations) Provisions to be used where applicable



Key

- Urban Development Boundary
- Urban Conservation Area
- Residential Terraced Development
- Clustered Residential Units (Refer to Table)
- Front Garden / Side Curtilage
- Green Areas
- Paved Area (Open space)
- Unopened Streets
- Water Course
- Stairway
- Scheme Alignment
- Existing Drainage Gallery
- Manhole

Scheme (2)

Scale :	Date :	Figure :
1:1000	April 2002	23(b)
INDICATIVE ONLY Not to be used for direct interpretation.		
Base Maps - 1988 Survey Sheets (Updated) Copyright Mapping Unit, Planning Authority		